



BCS CRANECAMERA

Installation guide for BCS Cranecamera systems:

VH-4010 & VH-4015



More Information:

✉ info@cranecamera.eu

🌐 www.cranecamera.eu

Office: ☎ +31 33 466 8938

Service: ☎ +31 6 159 561 05

BCS
CRANECAMERA

Set description:

Introducing the VH-4010 & VH-4015 cranecamera set.

Designed for mobile towercranes, this innovative system offers unparalleled functionality. Equipped with a unique electrical auto-tilt module, the camera maintains a stable viewing angle, ensuring a clear view of the hook or grab, regardless of the boom's angle.

The tilting angle is manually adjustable from within the cabin for optimized visibility.

Operate all system functions effortlessly using the multifunctional wireless zoom pedal. The set features a wireless transmitter/receiver for both video and control communication. The system offers advantages such as wind resistance, flexible mounting options, and adjustable viewing angles, guaranteeing an optimal view at all times.

The VH-4010 and VH-4015 cranecamera set includes a zoom camera, transmitter/receiver, wireless zoom pedal, lithium battery pack and an HD monitor. With specifications like shock and vibration resistance with robust casings and mounts, this set is built to withstand tough working environments while delivering reliable and exceptional performance.

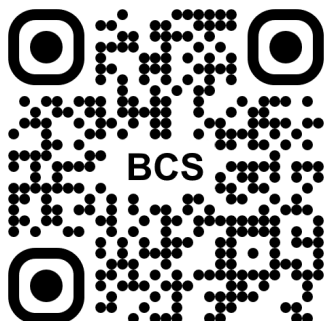

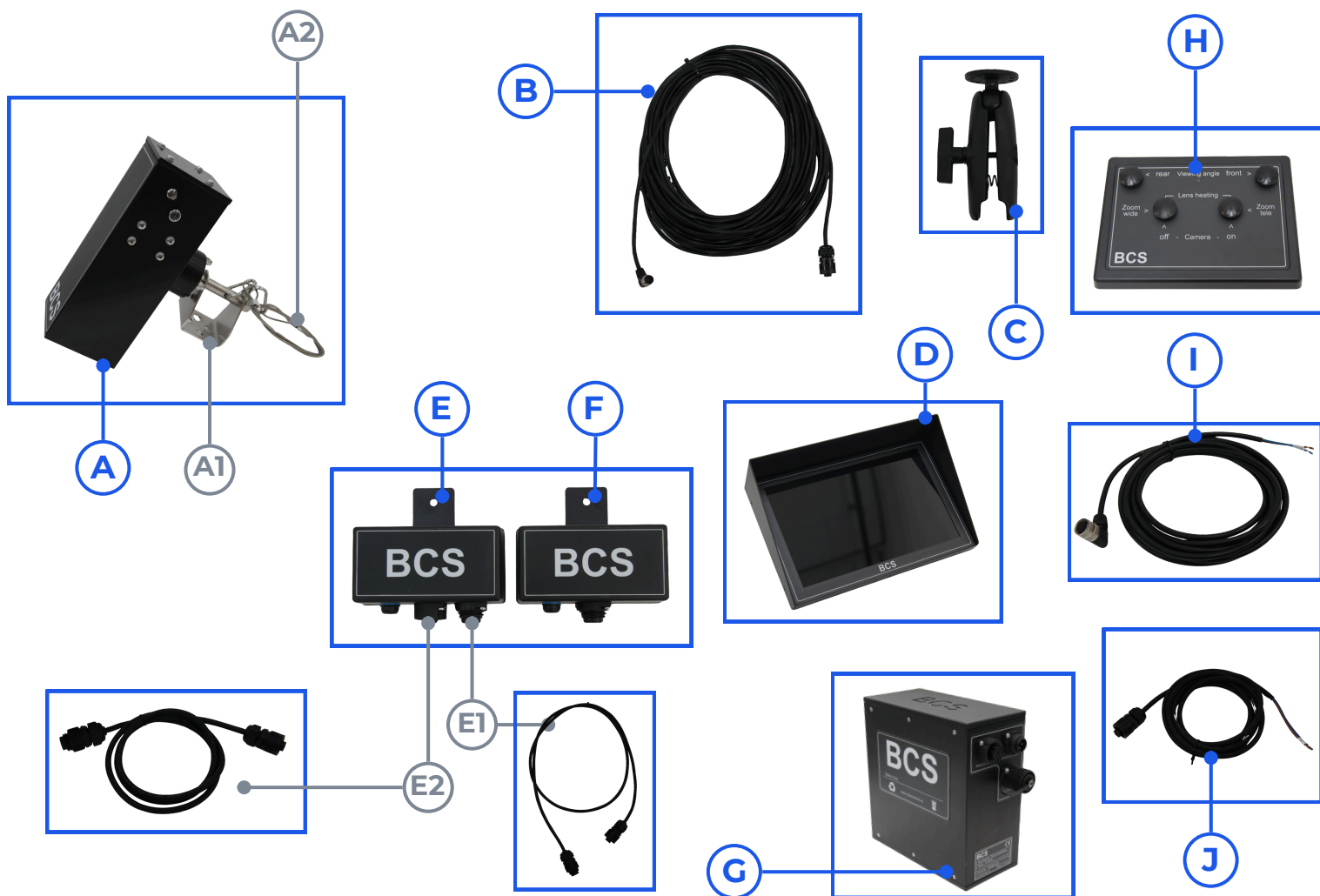

Component guide:

- **A:** Camera with zoom & tilt function
 - **A1:** Camera bracket
 - **A2:** Safety cord
- **B:** Video-data cable (5m)
- **C:** Ram-mount for monitor
- **D:** High-res widescreen monitor type LC (10" or 13") (24V)
- **E:** RAM-mount fixed transmitter
 - **E1:** Power cable for transmitter
 - **E2:** Video/data cable for camera
- **F:** Receiver on top of cabin
- **G:** Lithium-ion battery pack type LC + charge input (24V)
- **H:** Wireless zoom pedal type LC
- **I:** Monitor power cable (open-end, 5m)
- **J:** Chargedock cable from charge sleeves to batterypack LC (24V)

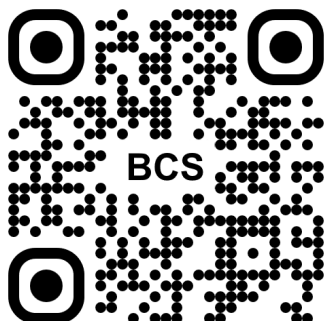



Component guide:

- **A:** Camera with zoom & tilt function
- **B:** Video-data cable (5m)
- **C:** Ram-mount for monitor
- **D:** High-res widescreen monitor type LC (10" or 13") (24V)
- **E:** RAM-mount fixed transmitter
 - **E1:** Power cable for transmitter
 - **E2:** Video/data cable for camera
- **F:** Receiver on top of cabin
- **G:** Lithium-ion battery pack type LC + charge input (24V)
- **H:** Wireless zoom pedal type LC
- **I:** Monitor power cable (open-end, 5m)
- **J:** Chargedock cable from charge sleeves to battery pack LC (24V)

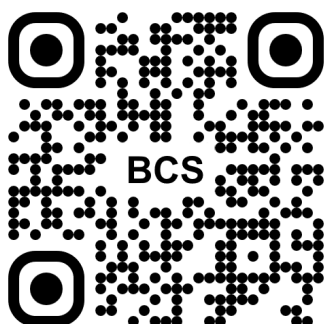

Component placement schematic:

(A) — -Mount camera (A) (with LED facing towards cabin; 10056664A)

(E) — Connect cable E1 from transceiver output on G to input on transmitter

-Connect Video/Data cable (E2) to camera. Make sure camera has enough space to tilt.

-Transmitter looking towards Receiver (F) as straight as possible.

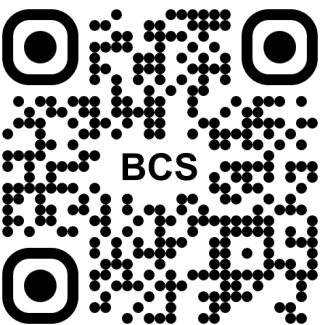
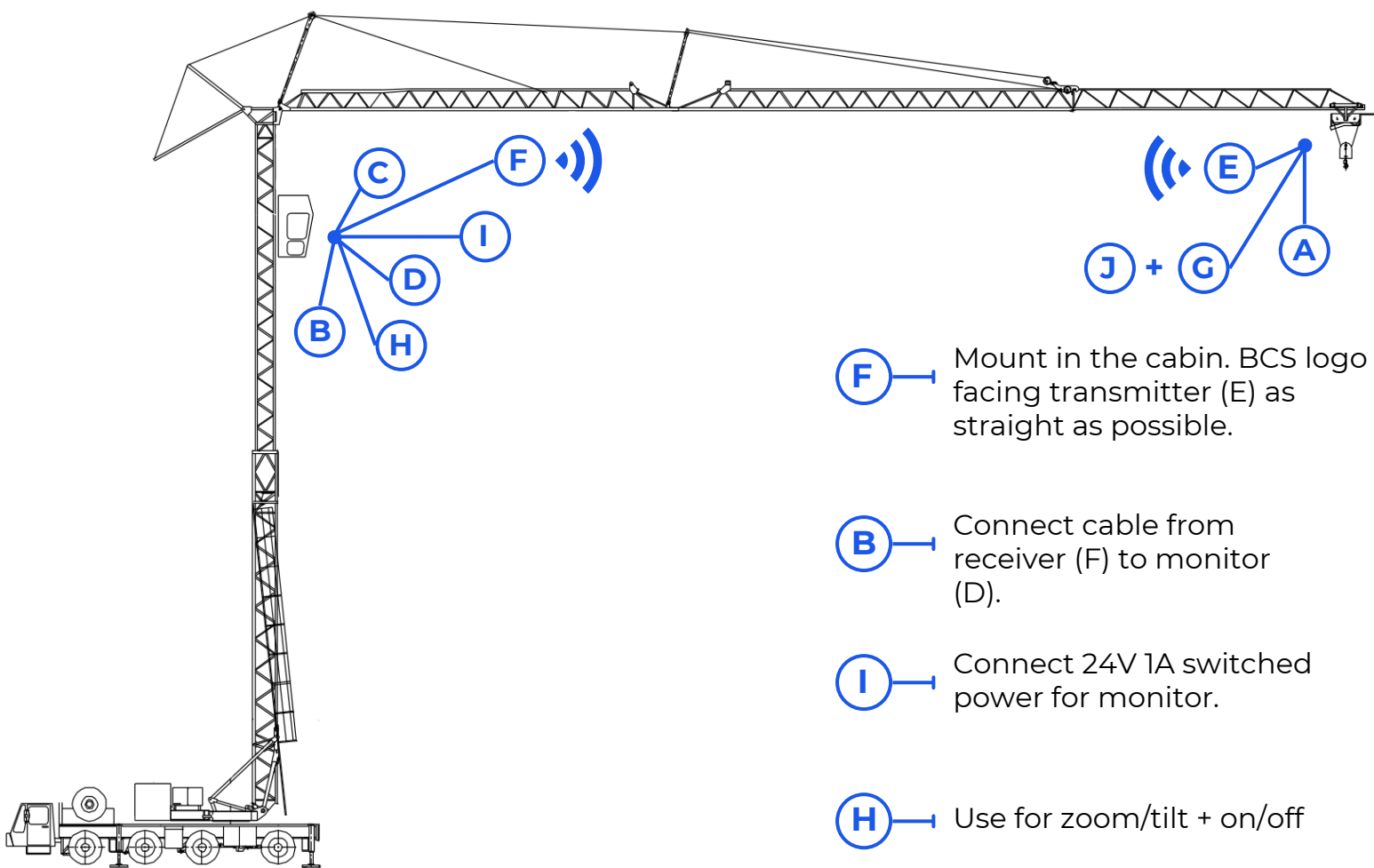

Side-buttons user manual for the high-res widescreen monitor:



Button guide:

- **1:** Open the menu to change color/crossline/input
- **2:** Navigate "Up"
- **3:** Navigate "Down"
- **4:** Navigate "Left"
- **5:** Navigate "Right"

To close the menu, press button 1.

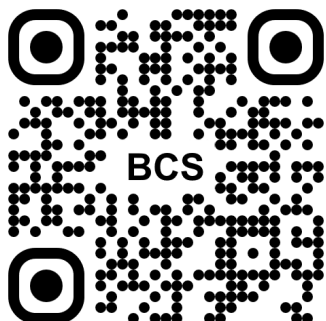

CONTROL DEVICE CRANECAMERASYSTEM



Viewing angle adjust:

Press "rear" to change the viewing angle to the front
Press "front" to change the viewing angle to the back

Zoom function:

Press "Zoom wide" to zoom out
Press "Zoom tele" to zoom in

Switching the camera on:

Press and hold "Zoom tele" to switch the camera and monitor on

Switching the camera off:

Press and hold "Zoom wide" for 10 seconds to switch the camera and monitor off

